

Euro Slat Foundation

You can adjust the support provided to any area of your body.

1. Your Euro Slat foundation is shipped in a standard configuration that provides shoulder and hip pressure relief for side sleepers and extra lumbar support for back sleepers.

2. Two blue adjusters is firmer than one. The further apart, the firmer the set of slats becomes.

3. Extra blue adjusters are shipped with your Euro Slat foundation. You may place these anywhere there are 3 slats in a set. The third (lower) slat can be moved to any set of slats.

Extra third slats and adjusters can be ordered.



Standard Configuration



Graduated Mid-body



Maximum Overall



Maximum Mid-body

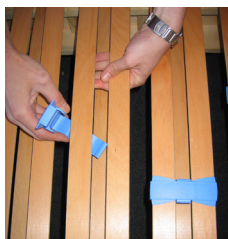
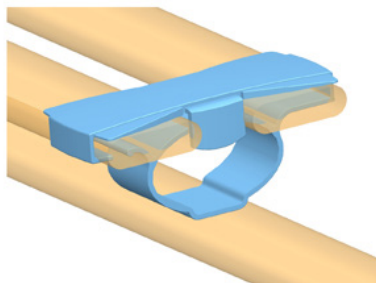

Slip open adjuster between top & bottom slats

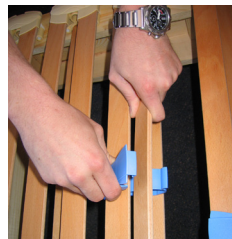

Close adjuster around top slats